

An aerial photograph of the New York City skyline at sunset. The sun is low on the horizon, casting a warm, golden glow over the city. The Freedom Tower is the most prominent building in the center. The water of the harbor is visible in the foreground, with several boats and a pier. The sky is a mix of blue and orange.

kpff

FULL-TIME
New York City, NY

ENGINEERING OPPORTUNITIES
CIVIL ENGINEERING PROJECT MANAGER

ENGINEERING CAREERS BUILT AROUND PEOPLE

At KPFF, we're more than engineers, we're collaborators, problem-solvers, and trusted partners helping shape communities across the country. With 35+ offices nationwide and licensed professionals in all 50 states, our teams combine local connection with national resources to take on meaningful and complex work. Our decentralized structure gives employees the opportunity to make an impact locally while still benefiting from the support, expertise, and collaboration of a larger national network.

Our Mission

We believe exceptional engineering starts with exceptional people. That's why we invest in mentorship, career growth, flexibility, and creating an environment where employees can thrive at every stage of their career.

Whether you're early in your career or stepping into leadership, KPFF offers the opportunity to work on impactful projects, build strong relationships, and help shape the future of the communities where we live and work.

Our culture is built on trust, collaboration, curiosity, and long-term thinking, creating a workplace where people are empowered to grow, contribute, and do meaningful work alongside great teams.

we are
ENGINEERS

we are
LEADERS

we are
MENTORS

we are
VOLUNTEERS

we are
INNOVATORS

we are
COLLABORATORS

we are
kpff



NATIONWIDE PROJECT HIGHLIGHTS



1



2

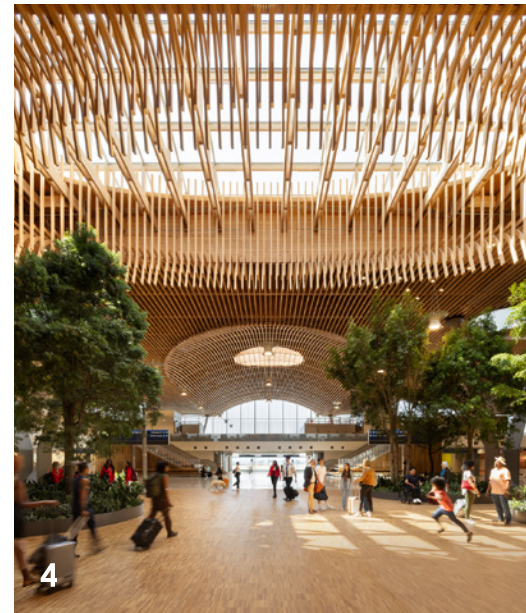

4



3



5



6



7

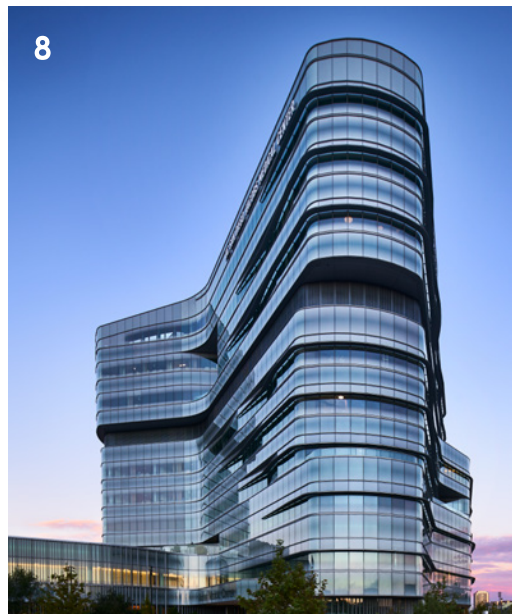

8



9



10

1. Chapman University Musco Center for the Arts - KPFF Los Angeles, CA | 2. Bill and Melinda Gates Foundation Campus - KPFF Seattle, WA
 3. San Diego Zoo The Jim and Diane Bashor Bridge - KPFF San Diego, CA | 4. Portland International Airport (PDX) Terminal Core Redevelopment - KPFF Portland, OR
 5. UC San Diego Altman Clinical & Translational Research Institute - KPFF Los Angeles, CA | 6. University of Idaho ICCU Basketball Arena - KPFF Boise, ID
 7. SR 520 Floating Bridge & Landing - KPFF Seattle, WA | 8. UC San Diego Jacobs Medical Center - KPFF Los Angeles, CA
 9. Lauridsen Amphitheater at Water Works Park - KPFF Des Moines, IA | 10. Cooley Landing Education Center - KPFF San Francisco, CA



CIVIL ENGINEERING PROJECT MANAGER

Job Description

We're hiring a Civil Project Manager to join our growing New York office in Tribeca. This is a strategic, client-facing leadership role focused on managing impactful civil engineering projects, building long-term client relationships, and supporting the continued growth of KPFF's presence in the New York market. At KPFF, you'll lead complex site development and infrastructure projects, mentor engineers, support business development efforts, and help shape the future of the office, all within a collaborative environment that offers leadership growth and pathways to ownership.

Key Responsibilities

- *Build strong client relationships, serve as a trusted project lead.*
- *Lead projects from proposal through construction, managing scope, schedules, budgets, and quality.*
- *Support business development through networking, proposals, and client growth opportunities.*
- *Help shape the strategic growth and market presence of KPFF's New York office.*
- *Provide technical leadership for site development and infrastructure projects.*
- *Coordinate with agencies, consultants, contractors, and internal teams to deliver successful projects.*
- *Mentor engineers and foster a collaborative, growth-focused team culture.*
- *Represent KPFF in client meetings, industry events, and professional organizations.*

QUALIFICATIONS

- + **BACHELOR'S DEGREE IN CIVIL ENGINEERING (MASTER'S PREFERRED)**
- + **PE LICENSE**
- + **8+ YEARS OF CIVIL ENGINEERING EXPERIENCE**
- + **PROJECT MANAGEMENT EXPERIENCE ON SITE DEVELOPMENT & INFRASTRUCTURE PROJECTS**
- + **CLIENT RELATIONSHIP & BUSINESS DEVELOPMENT EXPERIENCE**
- + **KNOWLEDGE OF NY/NJ PERMITTING & REGULATORY PROCESSES**
- + **PROFICIENCY IN AUTOCAD & CIVIL 3D**
- + **STRONG LEADERSHIP & COMMUNICATION SKILLS**
- + **PASSION FOR MENTORSHIP & TEAM DEVELOPMENT**
- + **COMMITMENT TO PROFESSIONAL GROWTH**

A CAREER BUILT TO SUPPORT YOU

Great work deserves meaningful support. At KPFF, we invest in our people by offering benefits, flexibility, and development opportunities designed to help you thrive – professionally and personally.



HEALTH & WELLNESS

Supporting your health, inside and outside of work.

- Two medical plan options through Cigna [Traditional OAP & High Deductible OAP with HSA]
- Dental coverage through Delta Dental
- Vision coverage through VSP
- Employer-paid life and disability insurance
- Health Savings Account (HSA) with employer contributions

\$1,200

CONTRIBUTED ANNUALLY TO EMPLOYEE HSAs



FINANCIAL BENEFITS

Investing in your future is part of building a long-term career.

- 401(k) with a 3% employer contribution
- No employee match requirement
- Flexible Spending Account (FSA) options
- Long-term financial planning support

3%

401(K) CONTRIBUTION



TIME AWAY & FLEXIBILITY

Programs designed to support balance and life outside of work.

- Generous paid time off and paid holidays
- Two floating holidays
- Flexible schedules and work-life integration
- Paid volunteer time

6 WEEKS

PAID FAMILY LEAVE



GROWTH & DEVELOPMENT

Mentorship, opportunity, and hands-on experience.

- Company-wide summits
- Leadership development programs
- Paid professional exams and licensure support
- Annual education budget and professional membership assistance
- Mentorship and advancement opportunities



COMPENSATION

Recognized and compensated for the time and effort you contribute.

- Paid for every hour worked
- Ability to bank extra hours for future flexibility
- Competitive compensation structure
- Semi-annual impact bonus opportunities



MENTAL HEALTH & EMPLOYEE SUPPORT

For you, your family, available anytime.

- Stress and burnout support
- Anxiety, grief, and depression resources
- Parenting and relationship support
- Legal and financial consultations
- Childcare and eldercare resources

AUSTIN
BIRMINGHAM
BOISE
COEUR D'ALENE
CHICAGO
CINCINNATI
COLUMBUS
DENVER
DES MOINES
EUGENE
IRVINE
INDIANAPOLIS
LA GRANDE
LACEY
LEXINGTON
LOUISVILLE
LOS ANGELES
LONG BEACH
MADISON
NASHVILLE
NEWPORT BEACH
NEW YORK CITY
PETALUMA
PORTLAND
SACRAMENTO
SALT LAKE CITY
SAN DIEGO
SAN FRANCISCO
SEATTLE
SPOKANE
ST. LOUIS
TACOMA
VANCOUVER
WASHINGTON, DC



299 BROADWAY, SUITE 700, NYC, NY 10007
212.973.3748 | www.kpff.com

